

IND/FT250

Dimensions: 2500 x 1000 x 140 mm (LxWxH). The total area is 2.5 m².

Color: The color of grass valleys is concrete gray.

Structure / shape: the grass valleys must have sufficient stiffness to prevent slipping. The surface structure is untreated.

Load class: BC6 (according to PTV-126) – Frequent heavy traffic. The characteristic load at 2 supports for BC6: 80 (N / mm).

SPECIFICATIONS DOCUMENT IND/FT250

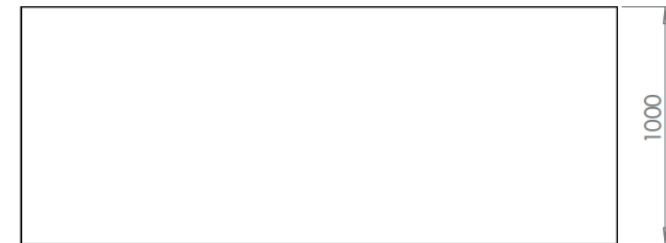
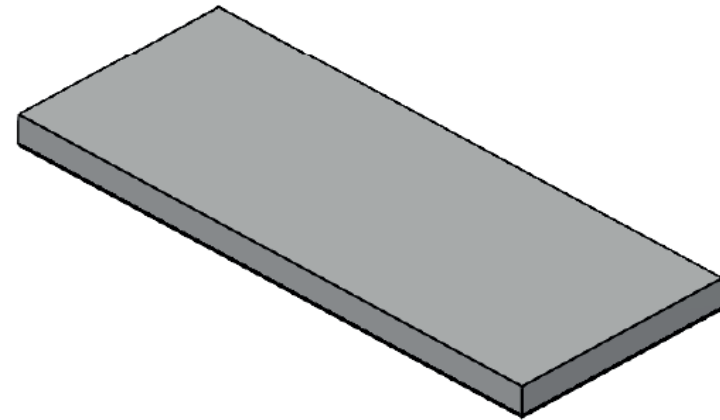

Foundation: continuous crushed stone 0/40 (type 1 according to SB 250) with thickness 35 mm

Strength class: C45/55 and is made with a limestone beat granulate for better durability.

Water absorption: max 5%

Steel quality: BE500ES

Rounding: > 25mm

Weight: 840 kg/st (336 kg/m²)

The grass pavers must harden in one for at least 24 hours closed damp room.

Drainage opening: 0 %

Lawn opening: 0 %

Fill volume: / L m². The grass pavers can be filled with broken crushed stone or a grass concrete mixture.

Technical specifications detail:

- Actual breaking load: minimum 1000 kg
- Suitable as water-permeable hardening
- Suitable as grass growth hardening
- Natural stone impact (1500 kg/m³): / kg/m²
- Grassy substrate (500 kg/m³): / kg/m²

Delivery & placement

The grass pavers must be delivered on pallets without wooden spacers that leave traces on the pieces. A good alternative can be nylon rope or plastic spacers.

Placement is done with a grass drop clamp or custom stone clamp for which two options are possible:

1. Stone clamp with metal bars that fit in the openings
2. Stone clamp equipped with plates of preferably 8 mm between which the grass valleys are clamped

Fine positioning can be done with a rubber hammer.

